

PLANIMETRIA SCALA 1:1000

Sezione con cunetta in rilievo
1:25

Committente
COMUNE DI PERDAXIUS

Progetto
MANUTENZIONE STRAORDINARIA
DELLE STRADE COMUNALI
IN LOC. IS PISTIS E CAMBONI
ESECUTIVO

Table with 2 columns: Data, Oggetto, A.C., A.C., Autore

STUDIO TECNICO
Geom. Antonio C. Gromella
Geom. Fabio Dochetta
SANT'ANNA ARRESI
antonio.gromella@tiscali.it
Tel./Fax 0781 968175

Scala VARIE Tav. 03
20.03.2016 I Committenti

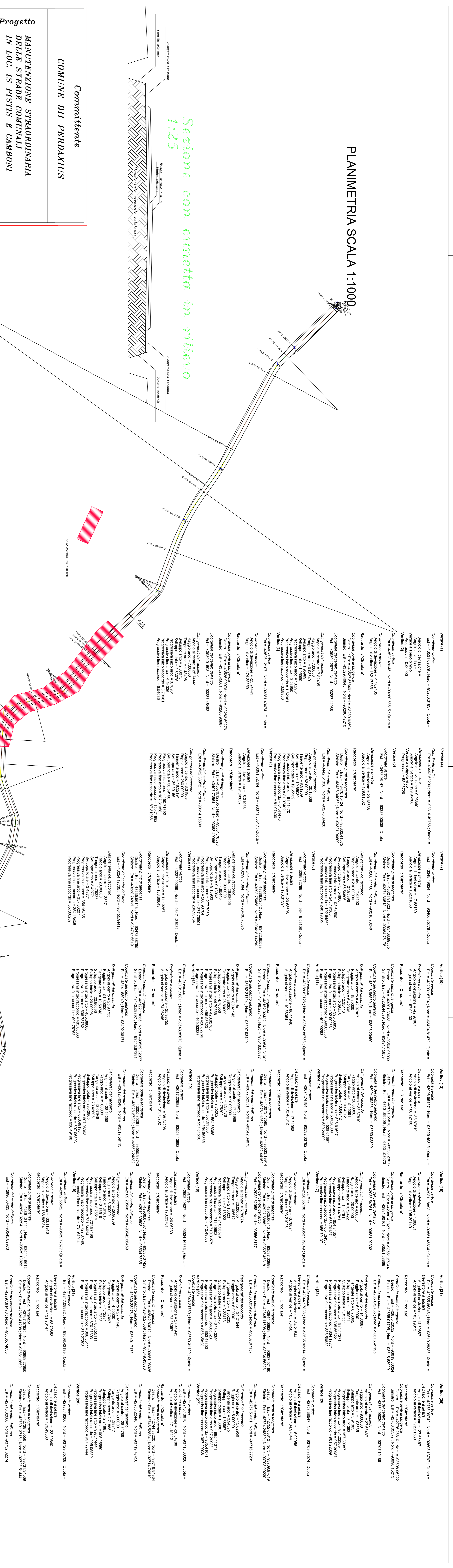
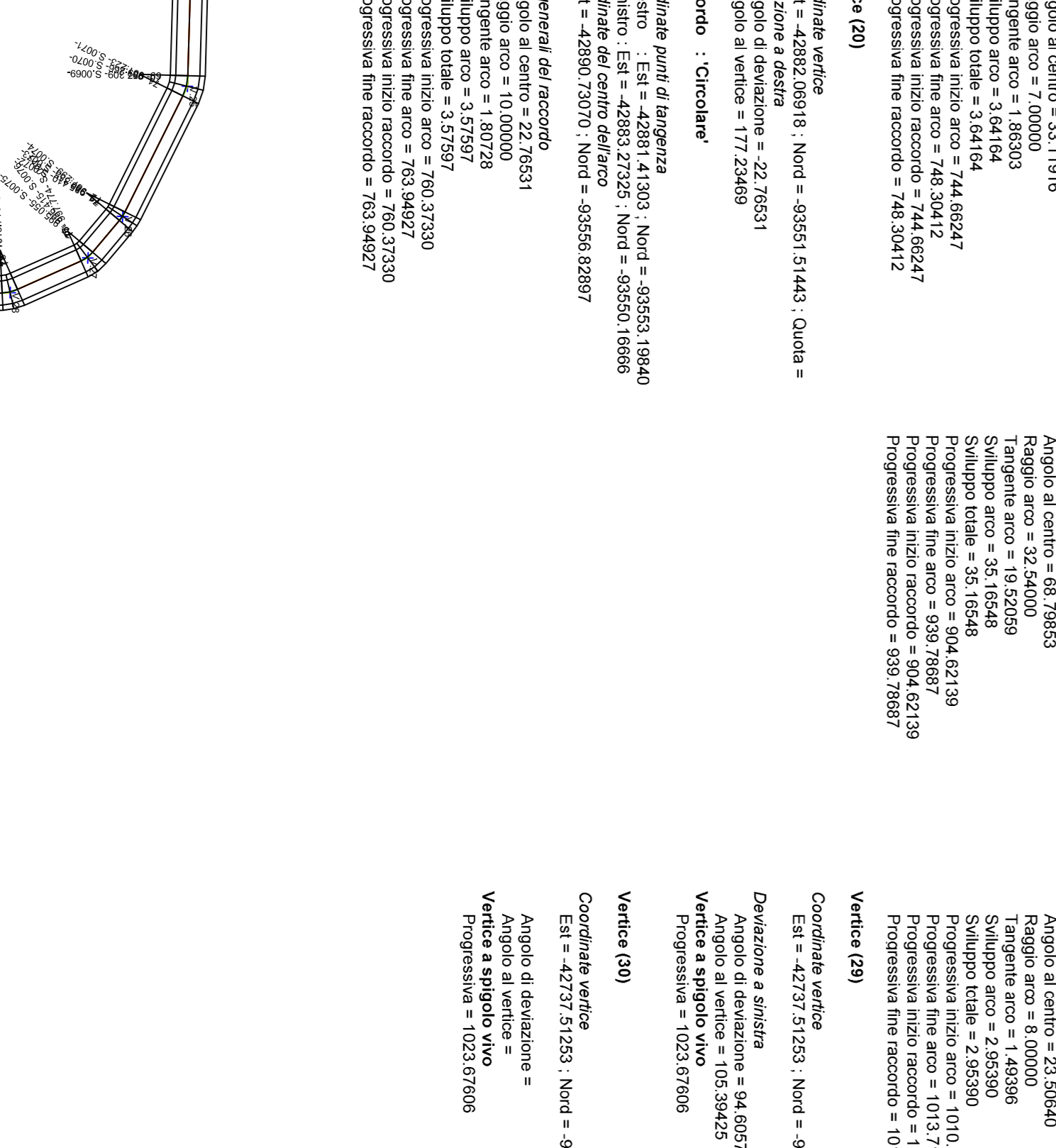
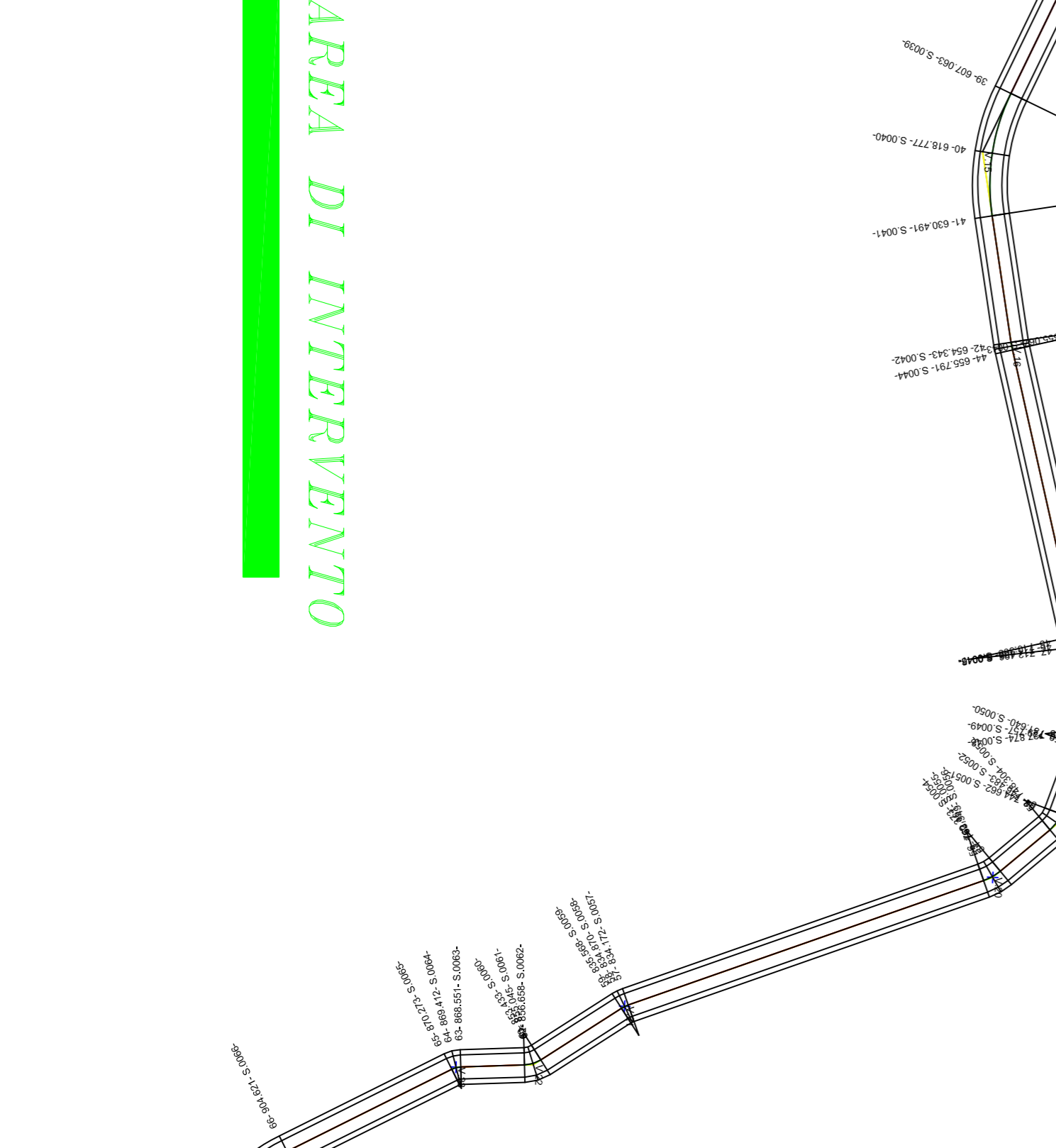
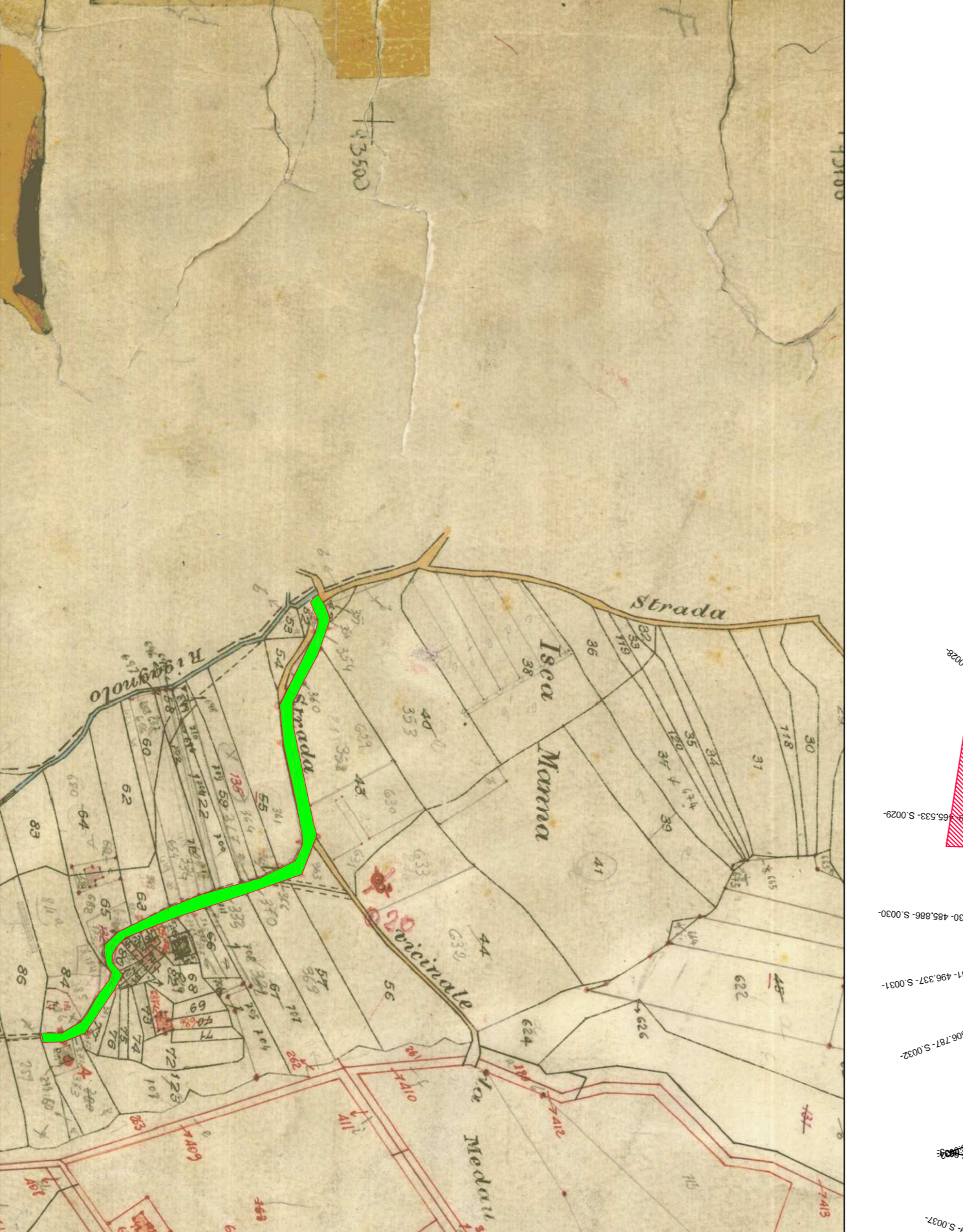

Vertical curve data for sections (1) through (28), including elevation, slope, and stationing information.

Technical specifications for road sections, including width, slope, and material requirements.

General notes and instructions for the construction and maintenance of the roads.

Additional technical details and specifications for the road sections.

Notes regarding the surveying and measurement data used in the planimetry.

Information regarding the project's location and the specific road sections being addressed.

Final remarks and conclusions regarding the project's execution and future maintenance.

Signature and stamp of the technical staff involved in the project.

Signature and stamp of the client, Comune di Perdaxius.

Additional technical details and specifications for the road sections.

Notes regarding the surveying and measurement data used in the planimetry.

Information regarding the project's location and the specific road sections being addressed.

Final remarks and conclusions regarding the project's execution and future maintenance.

Signature and stamp of the technical staff involved in the project.

Signature and stamp of the client, Comune di Perdaxius.

Additional technical details and specifications for the road sections.

Notes regarding the surveying and measurement data used in the planimetry.

Information regarding the project's location and the specific road sections being addressed.

Final remarks and conclusions regarding the project's execution and future maintenance.

Signature and stamp of the technical staff involved in the project.

Signature and stamp of the client, Comune di Perdaxius.

Additional technical details and specifications for the road sections.

Notes regarding the surveying and measurement data used in the planimetry.

Information regarding the project's location and the specific road sections being addressed.

Final remarks and conclusions regarding the project's execution and future maintenance.

Signature and stamp of the technical staff involved in the project.

Signature and stamp of the client, Comune di Perdaxius.

Additional technical details and specifications for the road sections.

Notes regarding the surveying and measurement data used in the planimetry.

Information regarding the project's location and the specific road sections being addressed.

Final remarks and conclusions regarding the project's execution and future maintenance.

Signature and stamp of the technical staff involved in the project.

Signature and stamp of the client, Comune di Perdaxius.

Additional technical details and specifications for the road sections.

Notes regarding the surveying and measurement data used in the planimetry.

Information regarding the project's location and the specific road sections being addressed.

Final remarks and conclusions regarding the project's execution and future maintenance.

Signature and stamp of the technical staff involved in the project.

Signature and stamp of the client, Comune di Perdaxius.

Additional technical details and specifications for the road sections.

Notes regarding the surveying and measurement data used in the planimetry.

Information regarding the project's location and the specific road sections being addressed.

Final remarks and conclusions regarding the project's execution and future maintenance.

Signature and stamp of the technical staff involved in the project.

Signature and stamp of the client, Comune di Perdaxius.

Additional technical details and specifications for the road sections.

Notes regarding the surveying and measurement data used in the planimetry.

Information regarding the project's location and the specific road sections being addressed.

Final remarks and conclusions regarding the project's execution and future maintenance.